

Recommended Maintenance Instructions for the Versis® Vertical Pressure Leaf Filter System

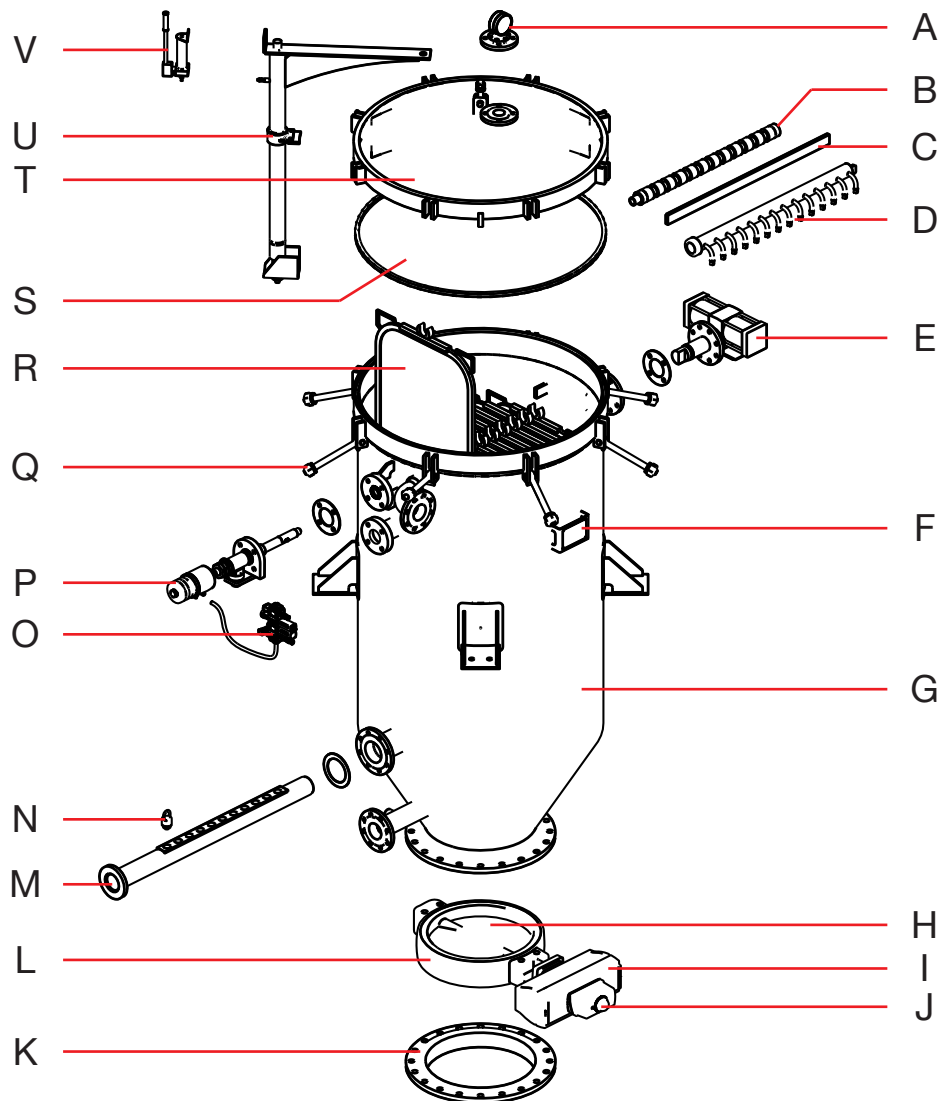

- | | | | |
|---|---------------------------|---|----------------------|
| A | Pressure Gauge | L | Bottom valve |
| B | Vibrator bar | M | Manifold |
| C | Anti Floating Bar (WCD) | N | Dummy Plug |
| D | Sluice Header Pipe (WCD) | O | Air Supply Unit |
| E | Sluice Header Drive (WCD) | P | Vibrator Unit |
| F | Name Plate | Q | Clamping Bolts |
| G | Pressure Filter Vessel | R | Pressure Filter Leaf |
| H | Valve disc | S | Cover gasket |
| I | Actuator | T | Cover |
| J | Bottom Valve Control Box | U | Cover lift |
| K | Flange | V | Hydraulic hand pump |

Regular maintenance

It is essential to regularly service and maintain pressure leaf filter systems as over time they will suffer from natural wear and tear. Regular cleaning and scraping of pressure filter leaves can also contribute to damage. When regular maintenance is not carried out, these factors can lead to significant process inefficiencies, resulting in increased maintenance interventions and higher operational costs.

Description code	Spare Part	Inspection	Maintenance when required
N	Air supply unit	Every 6 months	Change the seals if needed
N	Check the lubrication of the air unit	Once a month	Refill the lubricator with oil if needed
N	Check air filter	Once a month	Clean filter
B	Door Gasket	When opening filter	Replace if needed
L	Manifold	Yearly	Check dimensions of the holes Replace the manifold if needed
P	Clamping Bolts	Yearly	Lubricate
R	Hydraulic hand pump	Every 6 months	Check oil level
J	Bottom valve control box	Every 2 months	To review
K	Bottom valve	Every 2 months	Replace if needed
O	Vibrator Unit	Every 3 months	Change parts if needed
O	Counter nut / closing nut vibrator set	Once a week	Replace if needed
O	Vibrator Seal	Every 6 months	Replace seal set when there is a leakage
Q	Pressure Filter Leaves O'rings	With every exchange	Replace

amafilter
Filtration Group

Filtration Group BV - The Netherlands
www.filtrationgroup.com
Tel: +31 (0)573-297777

MODEL MODELL MODÈLE

MANUFACTURER HERSTELLER FABRICANT

SERIAL NO. FABRIK NR. NO. DE FABR. YEAR BUILT BAUJAHR ANNÉE DE FABR.

CHAMBER RAUM ENCEINTE

MAX. ALLOWABLE PRESSURE MAX. ZULÄSSIGER DRUCK PRESSION MAX. ADMISSIBLE PS bar

MAX./MIN. ALLOWABLE TEMPERATURE MAX./MIN. ZULÄSSIGER TEMPERATUR TS TEMPERATURE MAX./MIN. ADMISSIBLE °C

VOLUME VOLUMEN V L

TEST PRESSURE PRÜFDRUCK PRESSION D'ESSAI PT bar

TAG

Model identification plate

To request spare parts for your pressure filter leaf system, please provide Amafilter® with the filter system model and serial. This information can be obtained by checking the identification plate attached to the equipment (see enclosed drawing) or consult the equipment manual.

The information contained in this document does not replace the information contained in the Pressure Filter Leaf System Operation Manual, it has been put together as a generic guide, suitable for most existing vertical dry discharge filter systems.

In the event of any discrepancies between this instruction and that contained in the equipment manual, the one in the manual must be considered the correct version.

